

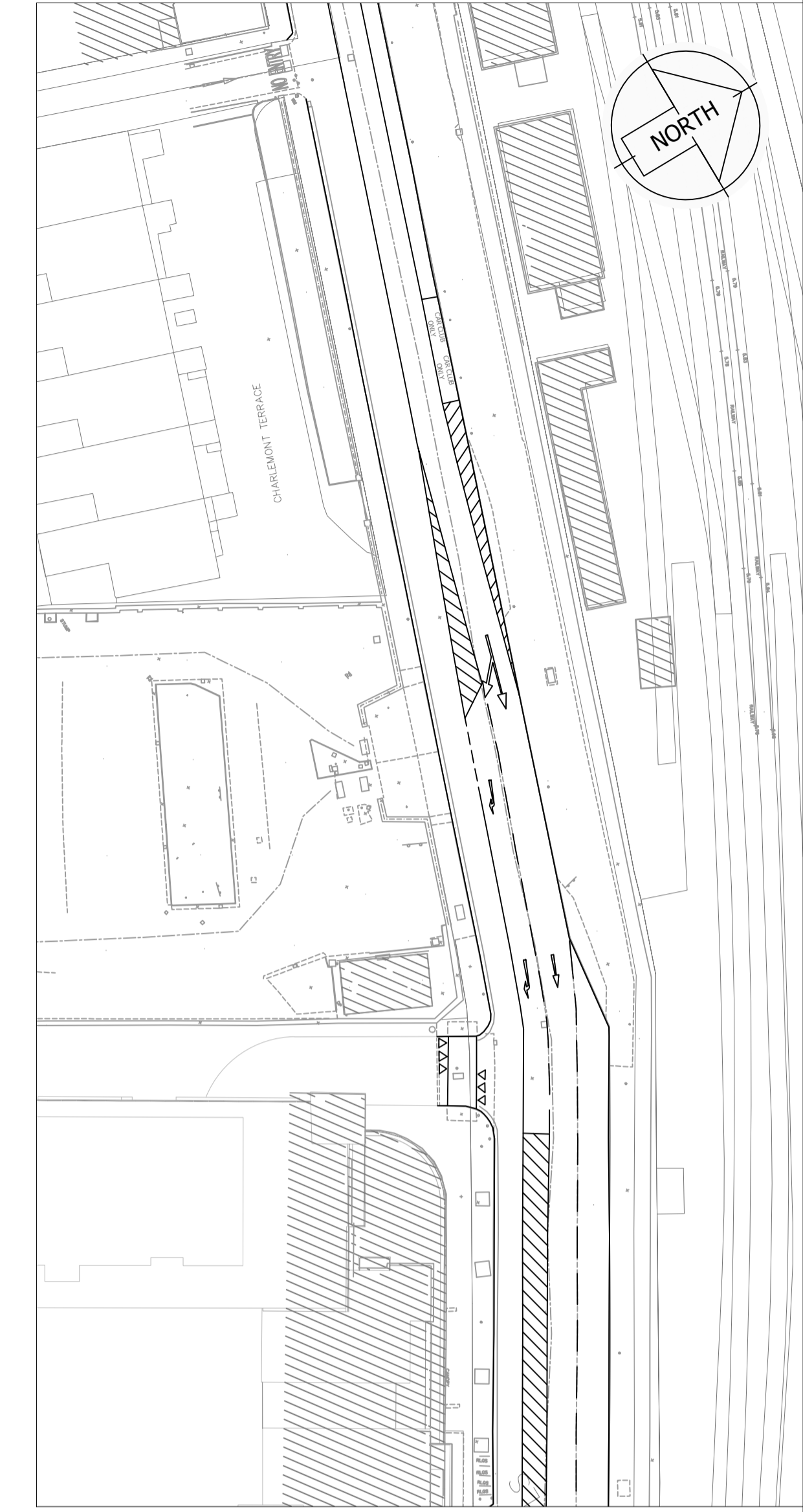

PROPOSED ROADS LAYOUT
SCALE 1:250



VISIBILITY SPYLA
SCALE 1:250



EXISTING CROFTON ROAD ACCESS ARRANGEMENT
SCALE 1:500

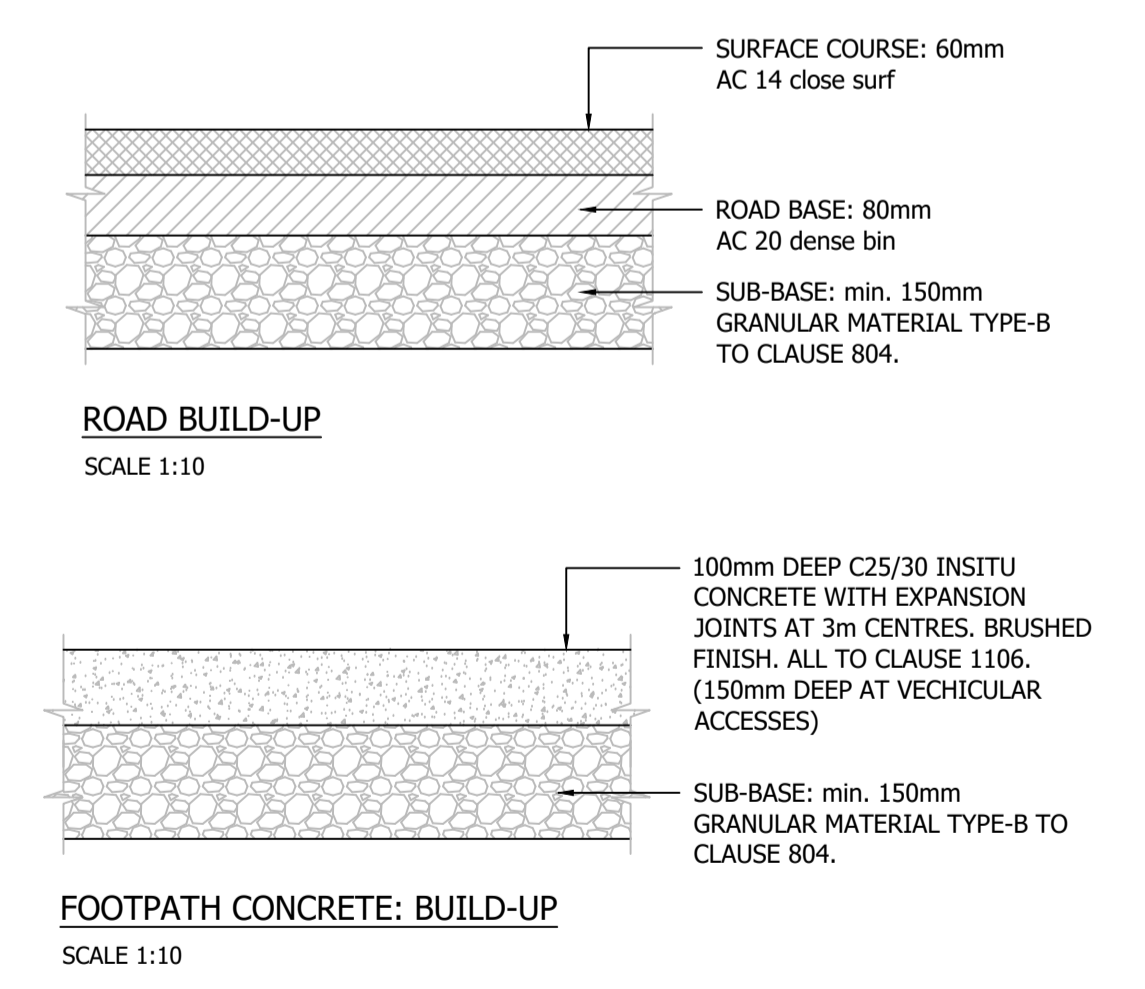

Copyright
No part of this document may be reproduced or transmitted in any form or stored in any retrieval system of any nature without the written permission of Muir Associates Ltd. as copyright holder except as agreed for use on the project for which the document was originally issued.

- NOTES:**
- ALL DIMENSIONS ARE IN METRES UNLESS SHOWN OTHERWISE.
 - DO NOT SCALE, USE FIGURED DIMENSIONS ONLY.
 - ALL ROADS ARE TO COMPLY WITH THE REQUIREMENTS OF DUN LAOGHAIRE RATHDOWN COUNTY COUNCIL.
 - ALL WORKS IN PUBLIC REALM SUBJECT TO AGREEMENT WITH DUN LAOGHAIRE RATHDOWN COUNTY COUNCIL.

LEGEND

PROPOSED ROAD LEVEL	+ 12.260
PROPOSED ROAD GRADIENT	1:40
EXISTING ROAD LEVELS	+ 12.260

Ordnance Survey Ireland Licence No. EN 0001720 © Government of Ireland

REVISION	DATE	DESCRIPTION	REV BY	CHK BY
A	21.10.20	ISSUED FOR PLANNING	SC	SS
B	25.11.20	REVISED AND REISSUED FOR PLANNING	SC	SS

Consulting Engineers
Project Managers
Muir Associates
Marketing Network House,
Angyle Square,
Morehampton Road,
Dublin D04 K0Y1, Ireland
Telephone: +353-1-6762788
email: info@muir.ie www.muir.ie

PROJECT	ST. MICHAELS DEVELOPMENT, DÚN LAOGHAIRE			
CLIENT	FITZWILLIAM DL LTD			
TITLE	ROADS LAYOUT AND VISIBILITY SPYLA			
Director SOR	Proj. Eng. SS	Drawn by SC	DRG. No.	REV
Scale AS SHOWN @A1	Checked SOR	Date OCT 20	D1855-C-01	B

PLANNING